

1 **ISO STARTER WALL**

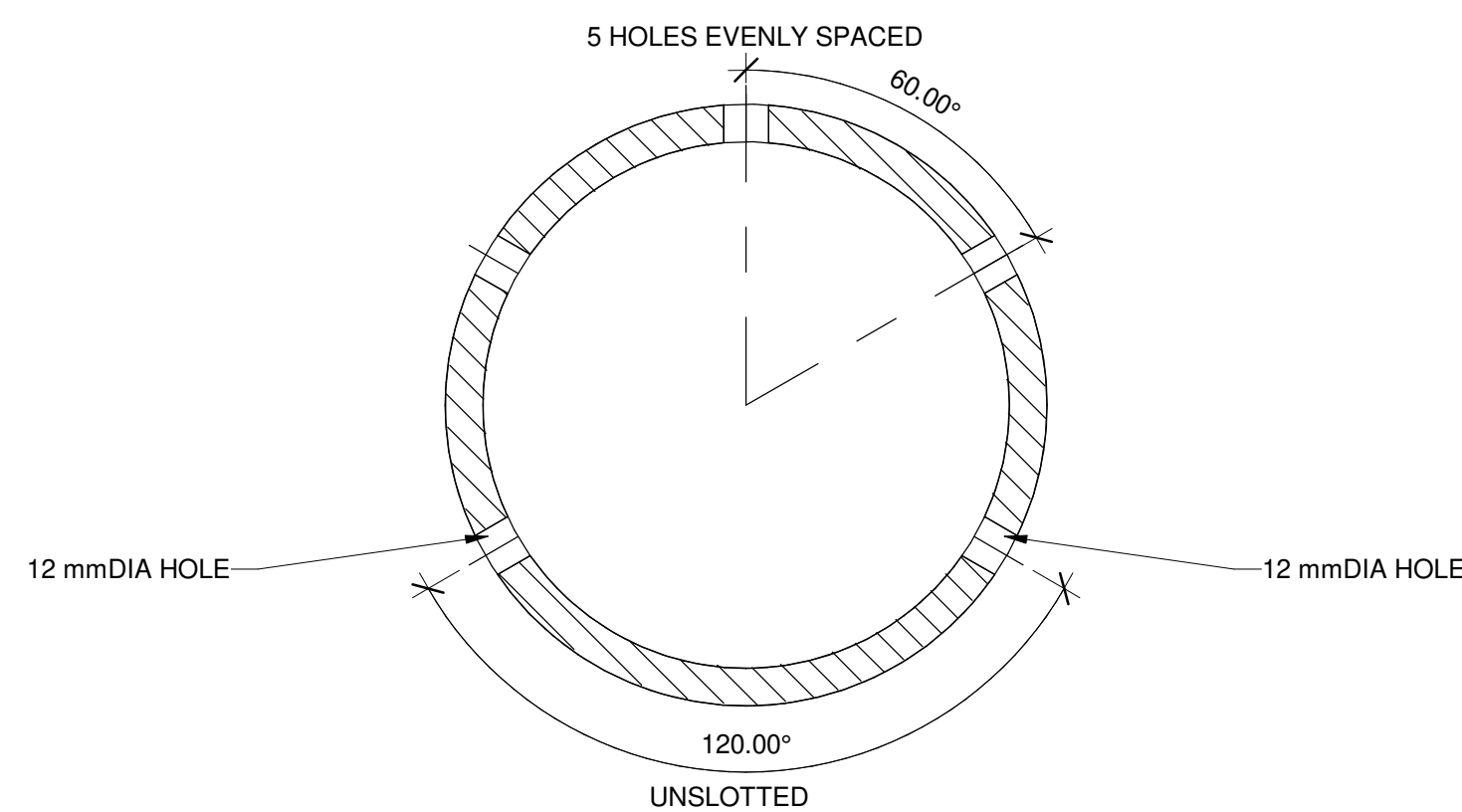

3 **DRILLED PIPE DETAIL**  
1 : 2

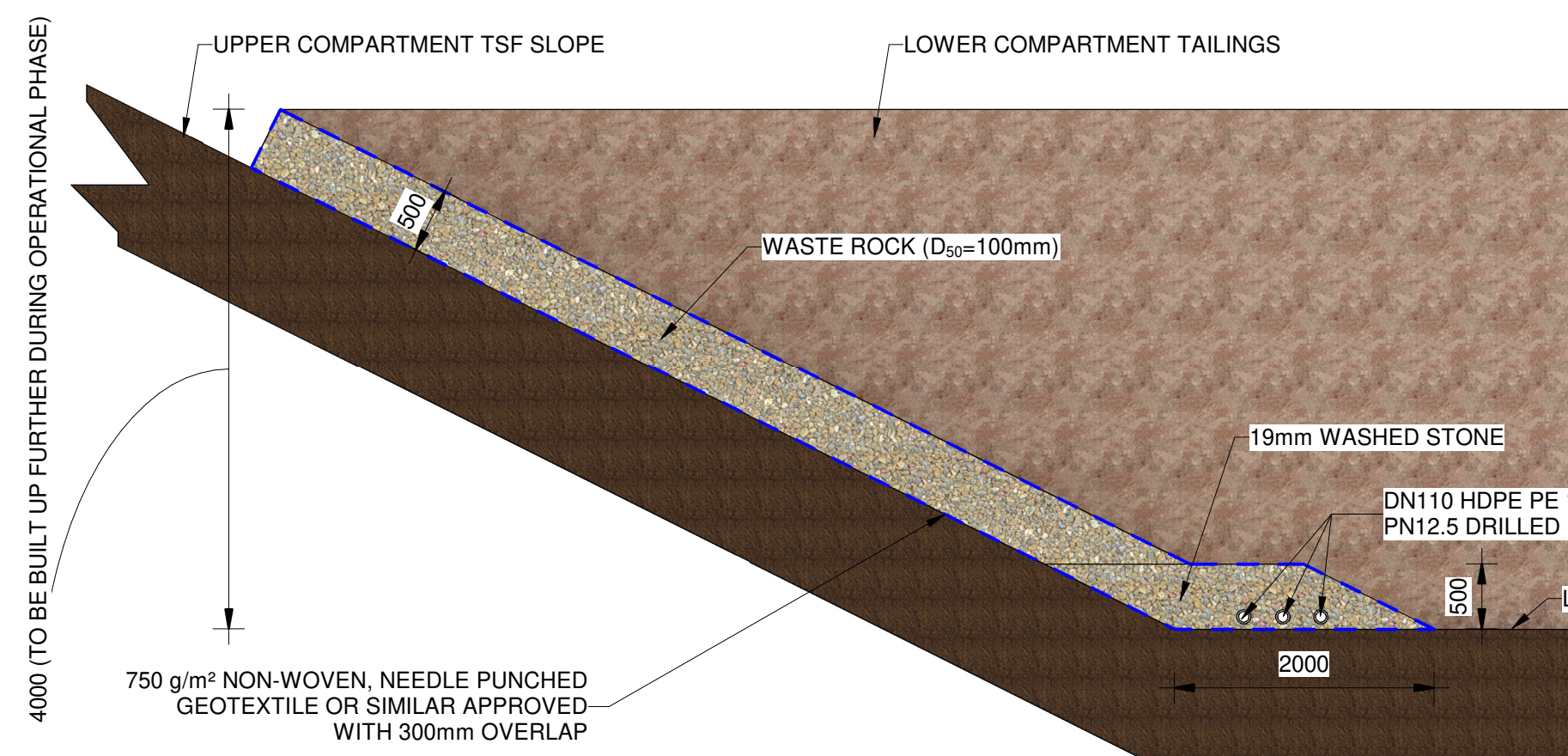

6 **TSF INTERFACE CURTAIN DRAIN DETAIL**  
1 : 50

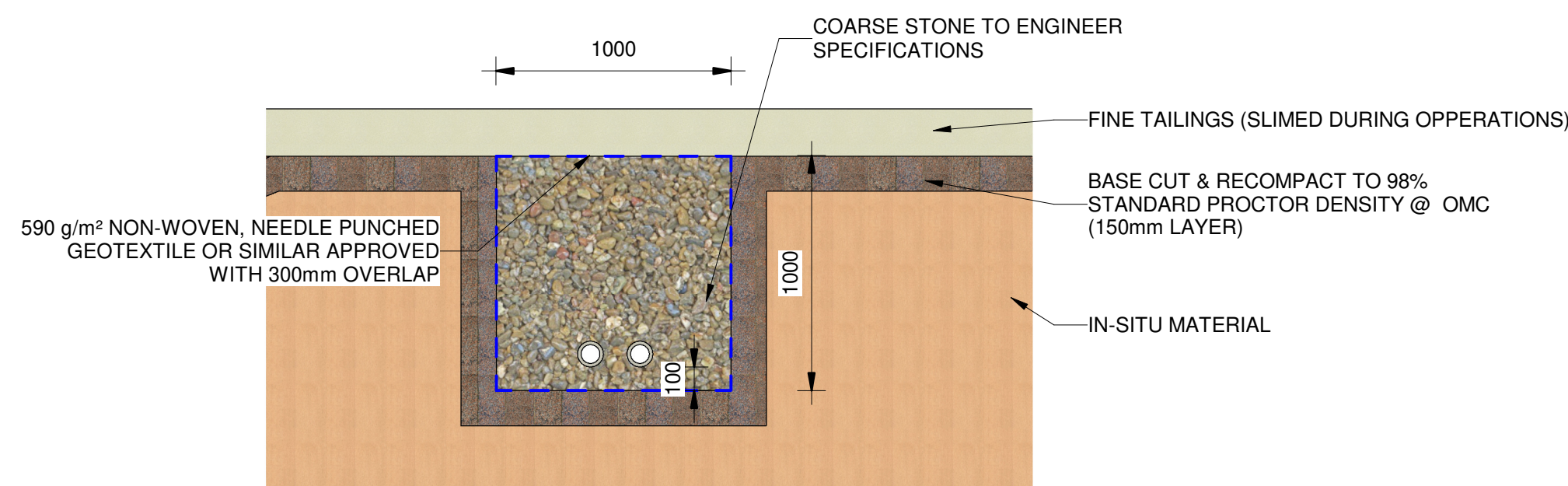

7 **TYPICAL LEACHATE DRAIN SECTION**  
1 : 25

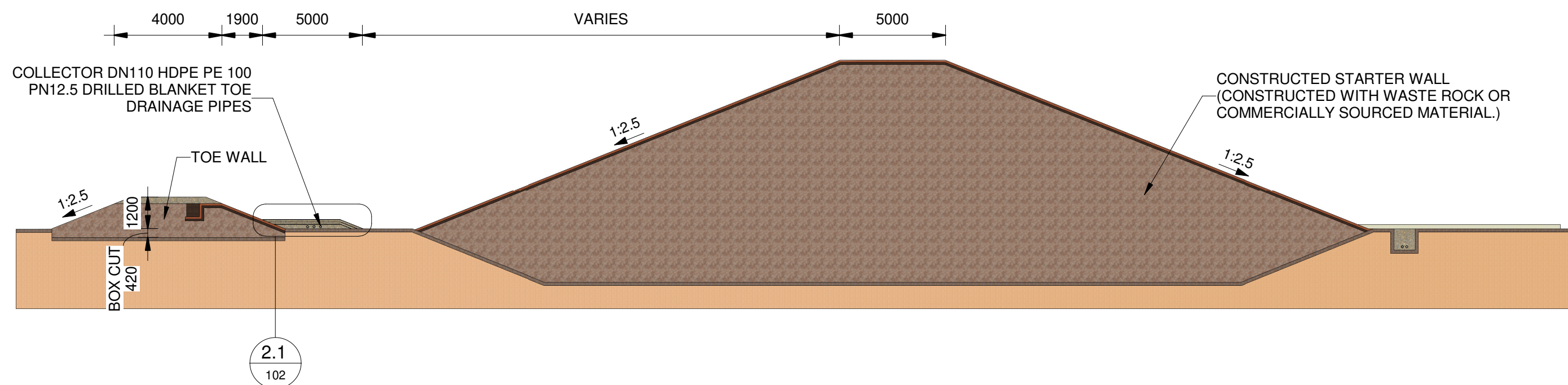

2 **TYPICAL STARTER WALL SECTION**  
1 : 200

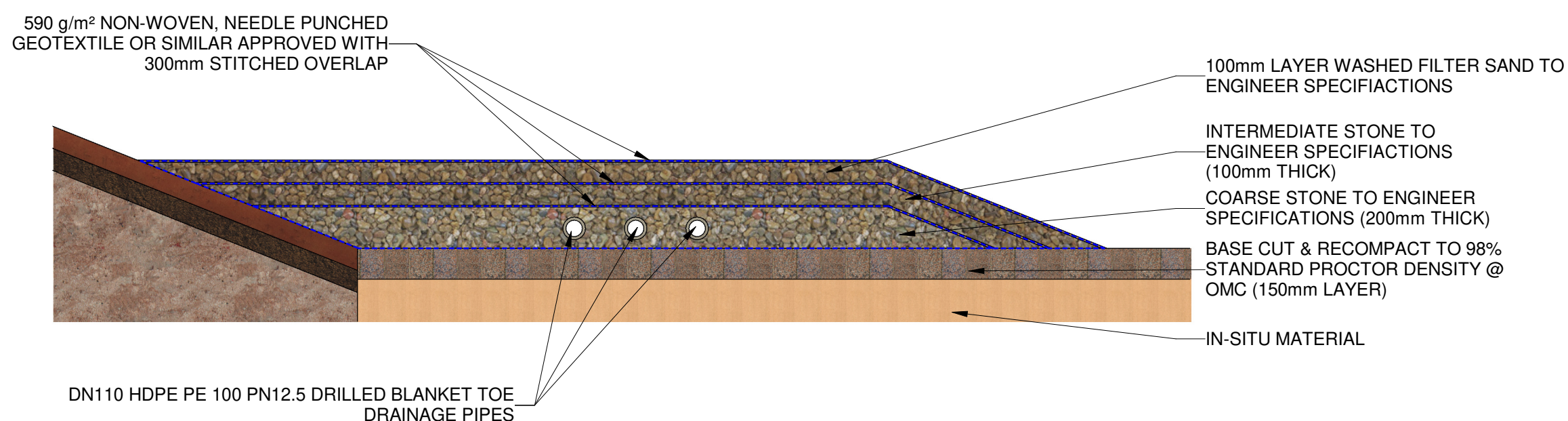

2.1 **TYPICAL STARTER WALL SECTION - Callout 1**  
1 : 25

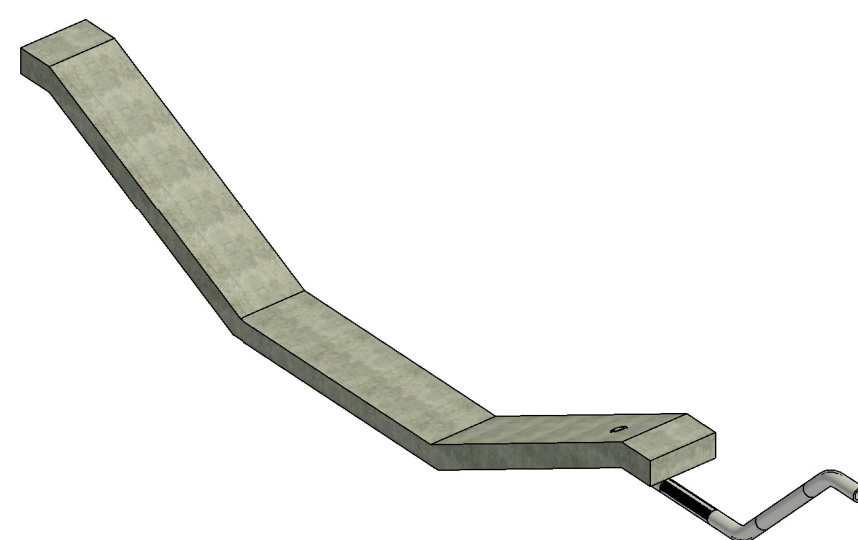

5 **ISO LEACHATE DRAIN OUTLET**

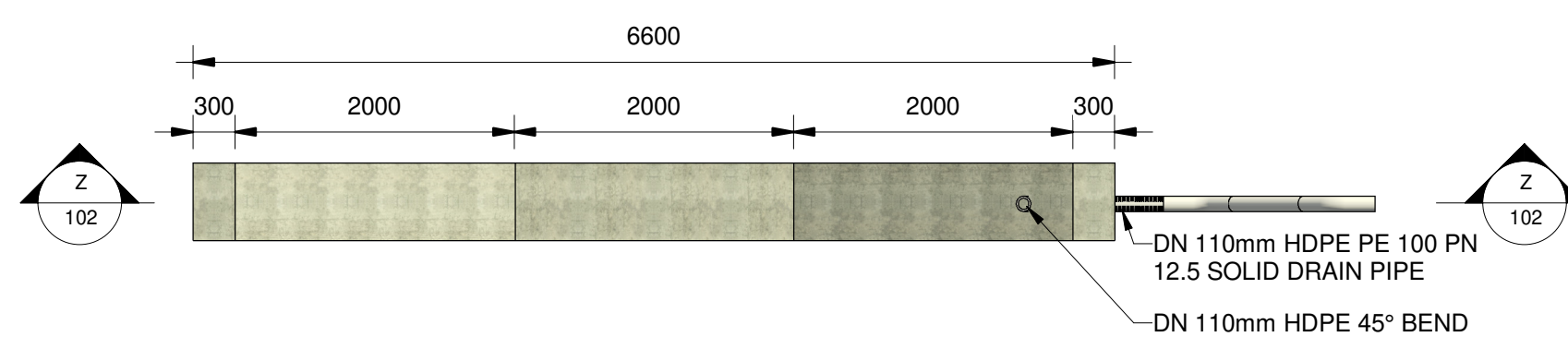

4 **PLAN - LEACHATE DRAIN OUTLET**  
1 : 50

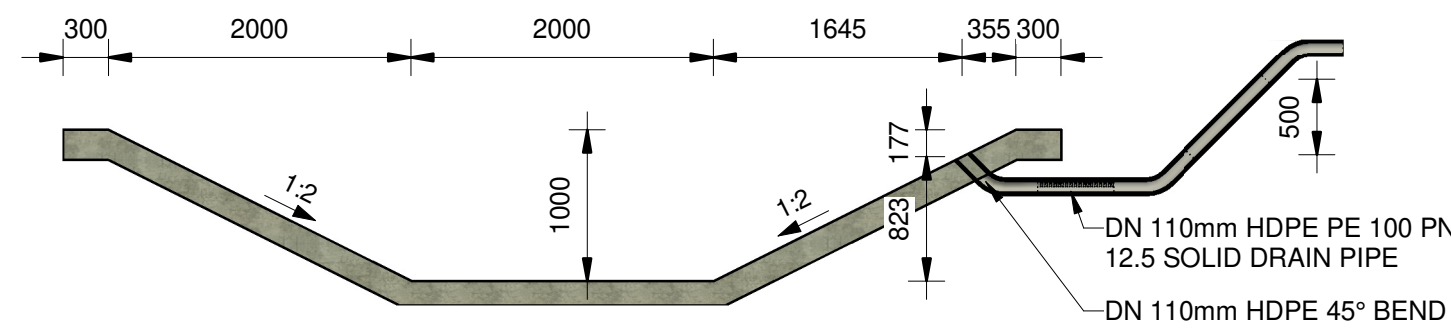

Z **SECTION Z-Z**  
1 : 50

#### EARTHWORKS NOTES

1. FINISHED BULK EARTHWORKS SHALL BE SMOOTH AND FREE FROM PROTRUSIONS THAT COULD PUNCTURE THE GEOMEMBRANE LINER AND SMALLER THAN 3mm
2. UNLESS OTHERWISE SPECIFIED ELSEWHERE, ALL EMBANKMENT FILL MATERIAL SHALL BE WASTE ROCK MATERIAL, COMPACTED TO 95% STANDARD PROCTOR DENSITY AT OMC 0% TO +2% IN LAYERS NOT EXCEEDING 250mm THICK
3. ALL GEOSYNTHETICS ANCHOR TRENCHES SHALL BE BACKFILLED WITH SELECTED MATERIAL STABILIZED WITH 5% CEMENT BY MASS PLEASE REFER TO THE PROJECT SPECIFICATION DOCUMENT FOR THE FILTER MATERIAL BANDS, SPECIFIED FOR THE LEACHATE DRAINS.

#### GEOSYNTHETICS NOTES

1. THE GEOMEMBRANE SHALL BE CLEAN AND DRY BEFORE SEAMING COMMENCES, SEAMING IN-LINE WITH SANS 10409 AND GRI-GM 19a AND 19b.
2. BAGS FILLED WITH SAND AND OR TAILINGS MATERIAL SHOULD BE TEMPORARILY PLACED ON THE HDPE LINER BASIN TO PREVENT UPLIFT CAUSED BY WIND. A PRELIMINARY GRID SPACING OF 5m X 5m CAN BE USED AND BE MODIFIED ON SITE WHEN NECESSARY.

NOT FOR CONSTRUCTION

#### REVISIONS

Rev	Date	Description	By
a	18/06/2025	ISSUED FOR CONCEPT	D.S

#### PROJECT STATUS

CONCEPT DRAWING	APPROVAL DRAWING	TENDER DRAWING	APPROVED CONSTRUCTION DRAWING	AS BUILT DRAWING
-----------------	------------------	----------------	-------------------------------	------------------

Design By	Date
R. I R	18/06/2025
Design Checked	Date
D.S	18/06/2025

Approval	Name:	Prof Reg Nr:
For Client:	Signature:	Date:
For Consulting Engineers:	D. SMITH Name:	Prof Reg Nr: 18/06/2025 Date:

Consultant	ECO ELEMENTUM (PTY) LTD 472 Botterklapper Street Block @ Nature Block B Die Wilgers, Pretoria East 0184 TEL: +27 (0)12 8070383
------------	--

Client	HARMONY GOLD MINING COMPANY PTY (LTD) PO Box 2 Randfontein 1760 South Africa
--------	---

Client Drawing Number	
-----------------------	--

Project	HARMONY GOLD MINING - MPONENG LOWER COMPARTMENT TSF
---------	--

Drawing Title	TAILINGS STORAGE FACILITY STARTER WALL AND DRAINAGE DETAILS
---------------	---

Paper Size	Sheet	Project No	Scale	Revision
A1	1 of 1	23-2486-5	AS SHOWN	a
Consulting Engineer's Drawing Number 23-2486-WMF-5-102				